

Panasonic
ideas for life

6 axis articulated arc welding robot

TA/TB Series

All new GIII controller !

Digital interface with "Full Digital" welding machine
achieving advanced weld performance.



TA-1400GIII



TB-1400GII

Panasonic pursues *Only one* in welding

TA/TB Series GIII

New hardware and software realizing advanced performance

All new controller with advanced performance !

- Faster and powerful CPU achieving half a minute quick boot up.
(50 % time saving compared with former model)
- Optimum kinematic calculation realizing faster acceleration and deceleration.
(Roughly 10 % air cut time reduction compared with former model)

NEW

GIII



All new teach pendant with easier operation !

Operating function key



User function key

Same basic operation procedure with former model
Windows based operation realizing easy use

- Light weight design under 1 kg (0.99 kg) giving you less stress during teaching
- Liquid crystal LED back light improving impact resistance
- USB and SD memory interface realizing great expandability
- Increased number of function keys (four to eight), enabling same action with less key strokes during teaching

Better and easier maintenance !

- Swivel rack mechanism realizing easy maintenance and space saving at the same time.
- Cables with connectors on both ends contributing to easier and shorter robot set-up or cable exchange.

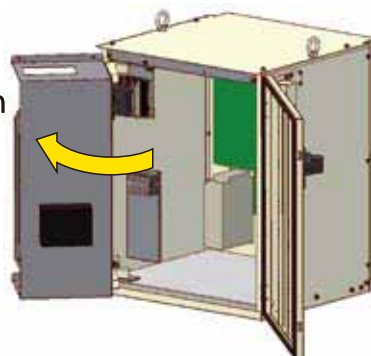

swivel rack mechanism

NEW

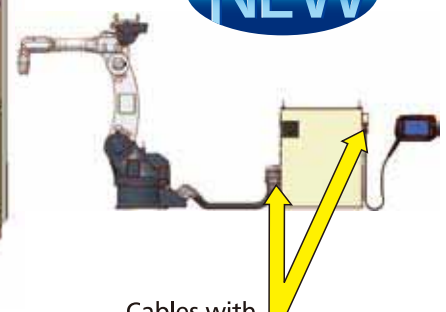

Cables with connector on both ends

TA/TB Series GII

Digital interfacing with Panasonic "Full Digital" welding machine achieving stable and advanced quality welding results

"High performance manipulator" optimized for the arc welding !



TA-1400

TA-1000

TA-1600

TA-1800

TA-1900

TA-GIII

- 1000
- 1400
- 1600
- 1800
- 1900

TB-GIII

- 1400
- 1800

Torch cable integrated type



TB-1400

TB-1800

Integrated torch cable creates less interference and improves accessibility!

Improved accessibility

Less interference with work piece or jig.

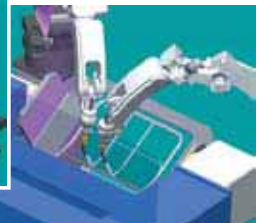

Less interference with multiple robot system

Robust arm with compact wrist design

Collision detection and flex-servo control !

Preventing torch miss-alignment due to collision

Manipulator detects unexpected force (collision) applied to the arm at a high sensitivity. Manipulator then changes its motion to flex-servo mode releasing the force preventing damage to the torch.

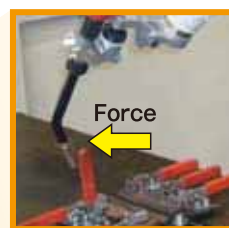

Detects collision at a high sensitivity

Manipulator quickly switches to flex-servo mode

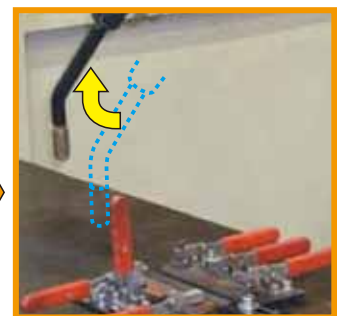

Manipulator can be easily moved away from collision scene. Quick recovery gives you more production

■ Dimensions of Manipulators (mm)

Short arm type **TA-1000** Max. Reach:1068 mm **GIII**

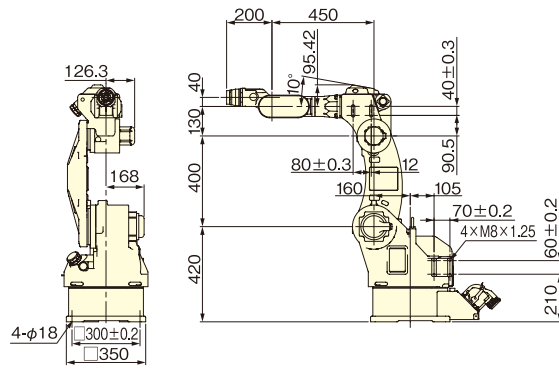

Standard arm type **TA-1400** Max. Reach:1374 mm **GIII**

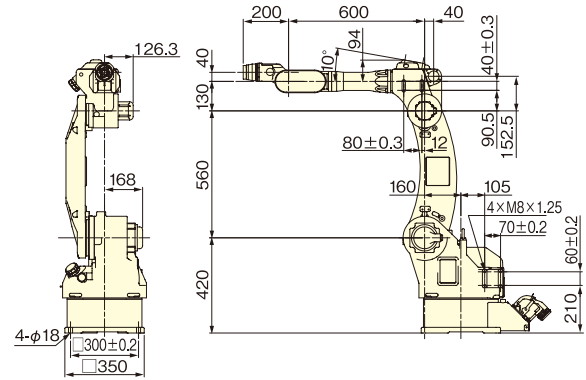

Middle arm type **TA-1600** Max. Reach:1598 mm **GIII**

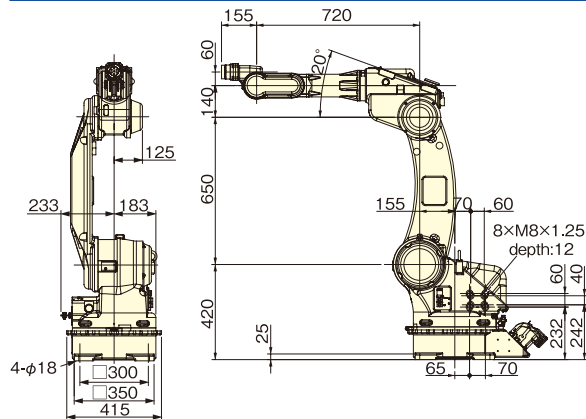

Long arm type **TA-1800** Max. Reach:1796 mm **GIII**

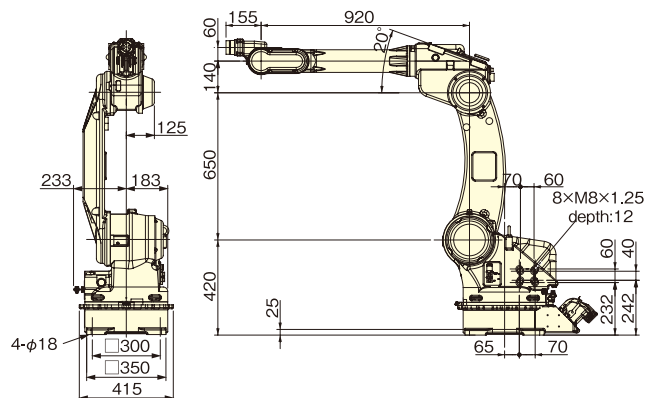

Long arm type **TA-1900** Max. Reach:1895 mm **GIII**

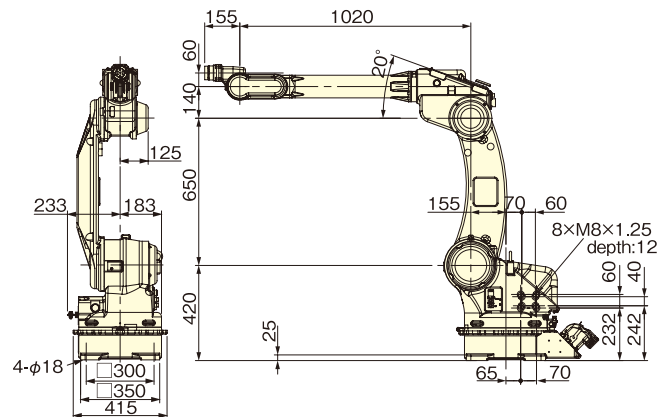

■ Standard specifications <Manipulators>

Model		TA-1000	TA-1400	TA-1600	TA-1800	TA-1900	TB-1400	TB-1800	
Type		Short arm	Standard arm	Middle arm	Long arm		Torch cable integrated		
Structure		Independent articulated							
Degree of freedom		6							
Maximum payload		6 kg		8 kg		6 kg	4 kg		
Robot working area	Maximum accessible distance	1068 mm	1374 mm	1598 mm	1796 mm	1895mm	1437 mm	1802 mm	
	Minimum accessible distance	362 mm	352 mm	360 mm	472 mm	551mm	376 mm	480 mm	
Momentary maximum speed	Arm	Rotation(RT)	2.97 rad/s (170° /s)				2.97 rad/s (170° /s)		
		Upper arm(UA)	3.32 rad/s (190° /s)		2.97 rad/s (170° /s)		2.97 rad/s (170° /s)		
		Front arm(FA)	3.32 rad/s (190° /s)		3.05 rad/s (175° /s)		3.32 rad/s (190° /s) 3.05 rad/s (175° /s)		
	Wrist	Rotating(RW)	6.46 rad/s (370° /s)		6.28 rad/s (360° /s)		5.93 rad/s (340° /s)		
		Bending(BW)	6.54 rad/s (375° /s)		6.11 rad/s (350° /s)		6.54 rad/s (375° /s)		
	Twisting(TW)	10.5 rad/s (600° /s)		9.42 rad/s (540° /s)		10.5 rad/s (600° /s)			
Positioning repetition precision		±0.1 mm or less			±0.15 mm or less		±0.1 mm or less		
Brake		All axis are provided with brakes							
Installation position		Floor, Ceiling (factory option)							
Weight of manipulator		About 145 kg	About 161 kg	About 203 kg	About 204 kg		About 171 kg	About 214 kg	

■ Dimensions of Manipulators (mm)

Torch cable integrated type **TB-1400** Max. Reach:1437 mm **GIII**

Torch cable integrated type **TB-1800** Max. Reach:1802 mm **GIII**

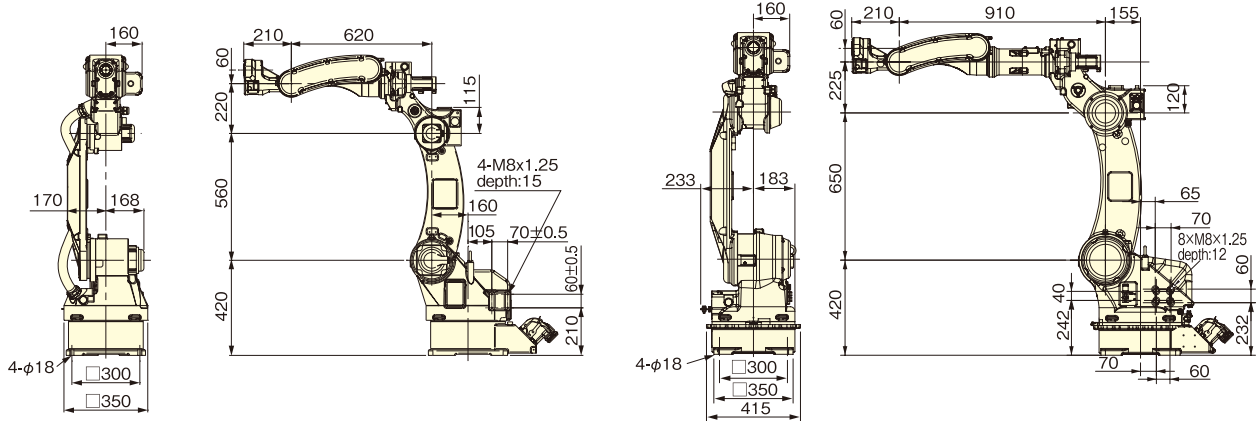

■ Specifications <Controller> (mm)

■ Controller

GIII

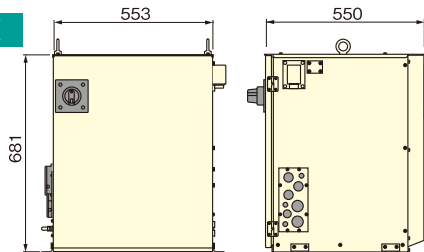

Model	GIII
Dimensions (mm)※1	(W) 553×(D) 550×(H) 681
Weight (kg)※2	60
Memory capacity	40 000 points
Position control method	Software servo control
External memory	Teach Pendant : SD memory card slot and USB2.0(Hi-speed not supported)2 ports
The number of control axes	6 axes simultaneously (Max.27 axes)
Input and output	Input:40 points (Option : expandable to 2048 points) Output:40 points (Option : expandable to 2048 points)
Input power source	3-phase,200-220 VAC±20 V,3 kVA,50/60 Hz

※1 : Protruding portions not included

※2 : Excluding the Teach Pendant and connecting cable

■ Teach pendant

GIII

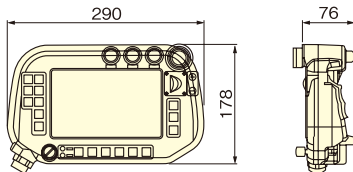

■ Dimensions of the wrist flange (mm)

TA Series

※Common between all TA types

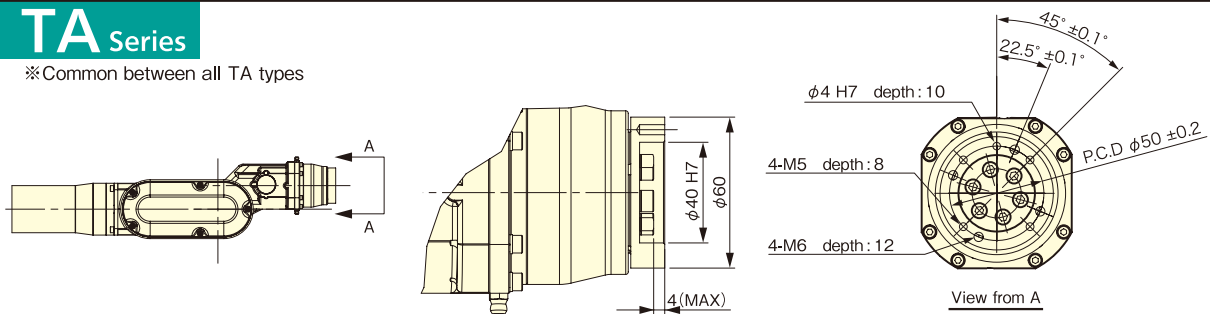

TB Series

※Common between all TB types

