



Welding Automation

PerformArc® 2200SS

Extremely High Productivity - Industry Leading

- Station indexing time is eliminated, allowing the robot to immediately begin welding on station B when station A is complete, gaining efficiencies and utilizing valuable time.
- Dual robot configuration is available, doubling throughput without requiring additional floor space.
- Standard load station jog provides complete load position flexibility, allowing multi-stage loading or tack and finish welding to occur in a common welding fixture.

Manufacturing Flexibility

- Our pre-engineered system is pre-wired and pre-assembled with a fully-welded frame. It's shipped to you in three sections for quick assembly and connection.
- The PA 2200SS features an open side wall design for easy changeover of holding fixtures or weldments by crane or forklift.
- For ever-changing production needs, the large rotation diameter and heavy payload capacity allow low-, mid- and high-volumes to be welded in single, multiple or progressive fixtures.

- Single- or dual-sided operation minimize interruptions and maximize throughput by allowing fixtures or parts to be changed while welding is occurring on the opposite side.
- The long headstock to tailstock span make large weldments possible.

FILTAIR® Weld Fume Extractor with Automation Hood

Designed for the rugged demands of robotic industrial welding operations, the FILTAIR Automation solution integrates the FILTAIR Weld Fume Extractor with the Automation Hood, providing a custom-engineered fume extraction solution.



PerformArc® 2200SS Automation Solution

Dimensional Specifications*

Cell width	A	5099.05 mm (200.75")
Cell depth	B	4991 mm (196.5")
Cell height	C	2286 mm (90")
Rotation height (from floor)	D	927.1 mm (36.5")
Rotation diameter	E	1525 mm (60")
Headstock-tailstock span	F	3048 mm (120")
Distance from rotation to light curtain CL	G	444 mm (17.5")
Light curtain opening	H	3873.5 mm (152.5")
Robot height (from floor)	I	1092.2 mm (43")
Robot distance (from CL of rotation)	J	1149.4 mm (45.25")
Positioner CL to positioner CL	K	1028.7 mm (90.5")
Robot CL to positioner face-plate	L	1525 mm (60")
Controls area width	M	2286 mm (90")
Controls area depth	N	890 mm (35")
Shipping weight main base		1360.777 kg (3000 lb)
Shipping weight wing pallet		273 kg (600 lb)
Shipping weight outboard base		1360.777 kg (3000 lb) x 2

*Note: All dimensions are approximate.

Top View

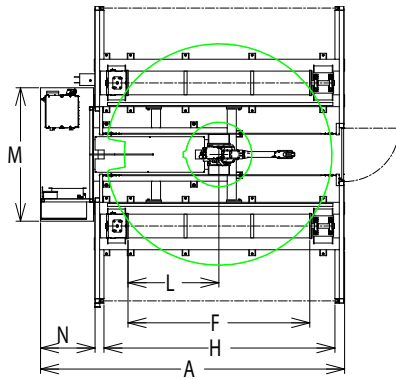

Side View

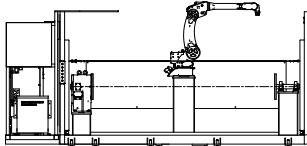

Front View

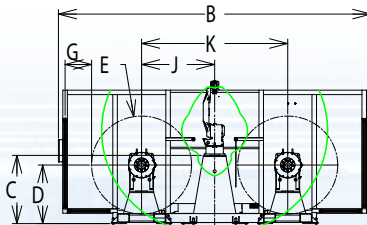

Standard Specifications

Fully Integrated Miller Welding Automation Total Solution Includes:

- Panasonic 6 kg arc welding robot
- Panasonic latest generation 64-bit controller with TFT color display teaching pendant utilizing Windows® CE
- Auto-Access® inverter arc welder
- Miller 4 drive roll wire feeder (dependent on your application)
- Tregaskiss™ 500 A air-cooled welding torch
- High speed servo positioners Type II 500 kg (2)
- Miller designed and manufactured total productivity system

System features include:

- (2) Integrated operator interfaces (E-Stop, Auto, Servo On, Hold, Start, Position Jog)
- (1) Full open hinged door for maintenance access
- TCP pointer and resident TCP check program
- Tip change monitor and maintenance program for easy torch upkeep
- Arc start retry, arc overlapping, flying arc start, password protection
- Resume function, shifting functions, online help function
- Standard remote axis jog (unlimited positional jog at operator load station)

Positioner General Technical Specifications

Model	Panasonic 1000 kg (2) Servo Positioner
Motor type	Panasonic 3.5 kW AC Digital Servo
Control type	Robot Servo Control
Payload (per side)	1000 kg (2200 lb)
Payload offset (from positioner CL)	Please consult manual
Through hole (for utility pass through)	75 mm (2.95")

Tooling Area Options

Standard headstock-tailstock width	10' (3048 mm, 120")
Standard rotation diameter	5' (1524 mm, 60")
Optional headstock-tailstock widths	8' (2438 mm, 96") 12' (3658 mm, 144")
Optional rotation diameters	5.5' (1676 mm, 66")
Optional payload	Available upon request

Robot Options

TA-1600G3
TA-1800G3
TA-1900G3
Dual Robot

Welder Options

	Miller (Standard)	Panasonic (Option)
Auto-Access 300 (Pulse/CV)		GB2-350 (CV)
Auto-Access 450 (Pulse/CV)		HM3-500 (Pulse/CV)
Auto-Access 675 (Pulse/CV)		WG (Pulse CV)
BP2-300 (TIG)		