

## Overview of different feeder types



**Pancake 2 - roll feeder with 1/25 gear ratio. Used in manual and robotic applications. Drive shaft size 10 mm. Select drive rolls with 10 mm bore.  
1 idle roll 1 drive roll.**  
The motor name plate markings are as follows:  
**Motor part code PMED12MA14K or Y706-14(A)K**



**Pancake 2 - roll feeder with 1/32 gear ratio. Used in manual and robotic applications. Drive shaft size 12 mm. Select drive rolls with 12 mm bore.  
1 idle roll 1 drive roll.**  
The motor name plate markings are as follows:  
**Motor part code PMMEE12MA22K or Y706-22K**



**Pancake 4 - roll feeder with 1/32 gear ratio. Used in manual and robotic applications. 3 - hole mounting pattern for drive rolls. Select drive rolls with 3- hole pattern. 4 drive rolls are needed.**  
The motor name plate markings are as follows:  
**Motor part code PMMEE12MA22K or Y706-22K**

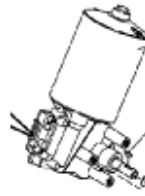

**Elmotor 2 - roll feeder . Used in manual applications. Drive shaft size 10 mm. Select drive rolls with 10 mm bore.  
1 idle roll 1 drive roll.**  
The motor name plate markings are as follows:  
**Motor part code Motor part code KSV50357**

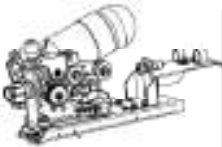

**Elmotor 2 - roll feeder. Used in robotic applications. Drive shaft size 10 mm. Select drive rolls with 10 mm bore.  
1 idle roll 1 drive roll.**  
The motor name plate markings are as follows:  
**Motor part code KSV50357**



**Elmotor 4 - roll feeder . Used in manual and robotic applications. 2 hole mounting pattern for drive rolls. 2 idle rolls 2 drive rolls or 4 drive rolls depending on application.**  
The motor name plate markings are as follows:  
**Motor part code KSV50357/MDK00020**



**Tawers 4 - roll feeder . Used in robotic applications. 2 hole mounting pattern for drive rolls. 2 idle rolls 2 drive rolls or 4 drive rolls depending on application.**  
The motor name plate markings are as follows:  
**Feeder part # APU01075/APU01079**



**4 - roll TIG feeder . Used in robotic applications. 2 hole mounting pattern for drive rolls. 2 idle rolls 2 drive rolls or 4 drive rolls depending on application.**  
The motor name plate markings are as follows:  
**Feeder part # TGF011\*\*\***

## 2-Roll Wire feeder EI motor

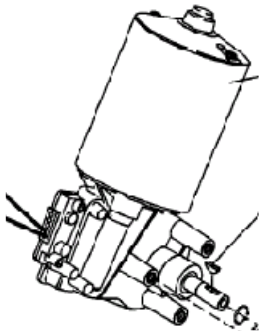

**Motor Shaft Ø 10mm**

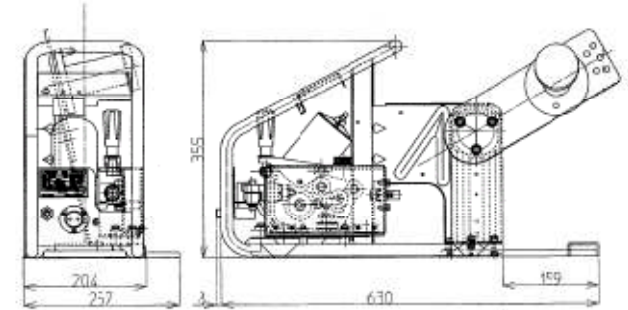

**Drive roll**

Wire Diameter Ø	V-Groove Steel	Knurled Steel	U-Groove	Idle Roll	Outlet guide	Key way	Drive roll screw
0.023"/ 0.023" ( 0.6 mm/ 0.6 mm )	MDR00021			MDR35101	MGT01608	XPB3A10	XVP4A10S (Wing Nut)  UMW00501 (Washer)
0.023"/ 0.030" ( 0.6 mm/ 0.8 mm )	MDR00806						
0.030"/ 0.030" ( 0.8 mm/ 0.8mm )	MDR00007						
0.035"/ 0.035" ( 0.9 mm/ 0.9 mm )	MDR00022						
0.030"/ 0.035" ( 0.8 mm/ 1.0 mm )	MDR01001						
0.035"/ 0.045" ( 0.9 mm/ 1.2 mm )	MDR01227	MDRC62100	MDRC62103				
0.045"/ 0.045" ( 1.2 mm/ 1.2 mm )	MDR01206						
0.052"/ 0.052" ( 1.4 mm/ 1.4 mm )	MDR01403						
0.045"/ 0.052" ( 1.2 mm/ 1.4 mm )	MDR01401						
0.052"/ 0.062" ( 1.2 mm/ 1.6 mm )	MDR01602		MDRC62104				
0.052"/ 0.062" ( 1.4 mm/ 1.6 mm )		MDRC62101					
0.062"/ 0.062" ( 1.6 mm/ 1.6 mm )	MDR01611						
0.062"/ 0.078" ( 1.6 mm/ 2.0 mm )	MDR02002						
0.078"/ 0.093" ( 2.0 mm/ 2.3 mm )		MDRC62102					
				MGT01205			
				MGT01608			
				MGT02005			

## 2-Roll Wire feeder with pancake motor 1/25 gear ratio



Motor part code PMED12MA14K or Y706-14(A)K

Motor Shaft Ø 10mm

Carbon brush part number: 0B1001 2pc.

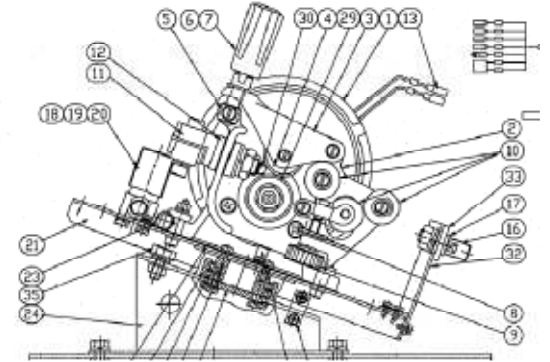

### Drive roll

Wire Diameter Ø	V-Groove Steel	Knurled Steel	U-Groove	Idle Roll	Outlet guide	Key way	Drive roll screw
0.023"/ 0.023" ( 0.6 mm/ 0.6 mm )	MDR00021			MDR35101	MGT00808	XPB3A10	XNH10G (Nut M10)  XWF10 (Washer)
0.023"/ 0.030" ( 0.6 mm/ 0.8 mm )	MDR00806						
0.030"/ 0.030" ( 0.8 mm/ 0.8mm )	MDR00007						
0.035"/ 0.035" ( 0.9 mm/ 0.9 mm )	MDR00022						
0.030"/ 0.035" ( 0.8 mm/ 1.0 mm )	MDR01001						
0.035"/ 0.045" ( 0.9 mm/ 1.2 mm )	MDR01227	MDRC62100	MDRC62103				
0.045"/ 0.045" ( 1.2 mm/ 1.2 mm )	MDR01206						
0.052"/ 0.052" ( 1.4 mm/ 1.4 mm )	MDR01403						
0.045"/ 0.052" ( 1.2 mm/ 1.4 mm )	MDR01401						
0.052"/ 0.062" ( 1.2 mm/ 1.6 mm )	MDR01602		MDRC62104				
0.052"/ 0.062" ( 1.4 mm/ 1.6 mm )		MDRC62101					
0.062"/ 0.062" ( 1.6 mm/ 1.6 mm )	MDR01611						
0.062"/ 0.078" ( 1.6 mm/ 2.0 mm )	MDR02002						
0.078"/ 0.093" ( 2.0 mm/ 2.3 mm )		MDRC62102					
					MGT01205		
				MGT01608			
				MGT02005			

## 2-roll Wire feeder with pancake motor 1/32 gear ratio



Motor part code PMMEE12MA22K or Y706-22K

Motor Shaft Ø 12mm

Carbon brush part number: 0B1001 2pc.

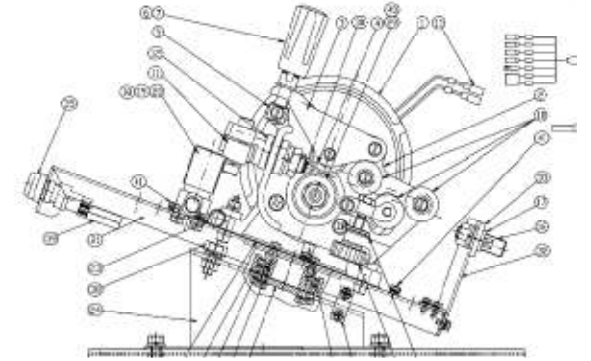

### Drive roll

Wire Diameter Ø	V-Groove Steel	Knurled Steel	U-Groove	Idle Roll	Outlet guide	Key way	Drive roll screw
				MDR35101	MGT00808	XPB3A10	XNG12
0.030"/ 0.035" ( 0.8 mm/ 1.0 mm )	MDR00906				MGT01205		
0.035"/ 0.045" ( 0.9 mm/ 1.2 mm )	MDR01218	MDRCT09264			MGT02005		
0.040"/ 0.040" ( 1.0 mm/ 1.0 mm )	MDR01008				MGT02005		
0.045"/ 0.045" ( 1.2 mm/ 1.2 mm )	MDR01213		MDR01607				
0.045"/ 0.052" ( 1.2 mm/ 1.4 mm )	MDR01405						
0.052"/ 0.052" ( 1.4 mm/ 1.4 mm )	MDR01406						
0.045"/ 0.062" ( 1.2 mm/ 1.6 mm )	MDR01610						
0.052"/ 0.062" ( 1.4 mm/ 1.6 mm )		MDRCT09265					
0.062"/ 0.062" ( 1.6 mm/ 1.6 mm )	MDR01608						
0.062"/ 0.078" ( 1.6 mm/ 2.0 mm )							
0.078"/ 0.093" ( 2.0 mm/ 2.3 mm )		MDRCT09266					

## Aluminium 4-roll wire feeder with pancake motor 1/32 gear ratio

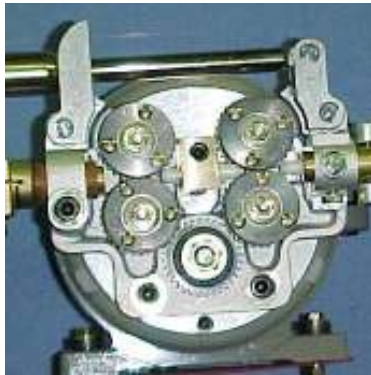

- Motor part code PMMEE12MA22K**
- 3- hole mounting pattern/ screw part # YZA95**
- Carbon brush part number: 0B1001 2pc.**

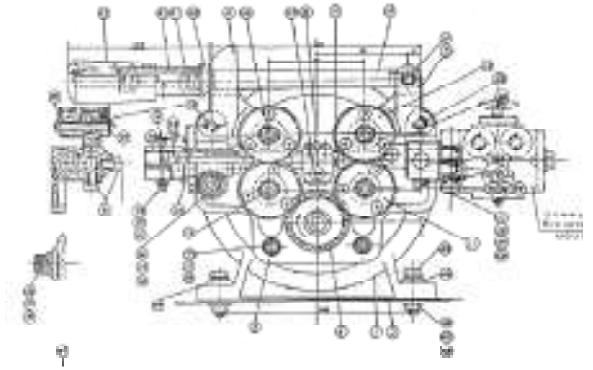

**Drive roll**

Wire Diameter Ø
0.035"/ 0.045" ( 0.9 mm/ 1.2 mm )
0.045"/ 0.062" ( 1.2 mm/ 1.6 mm )
0.096"/ 0.096" ( 2.4 mm/ 2.4 mm )

U-Groove Steel
MDR02419
MDR02423
MDR02421

Outlet guide collared
MGW00905
MGW01208
MGW01614
MGW01614

Outlet guide uncollared
MGW00907
MGW01214
MGW01631
MGW01631

Center guide
MGW00810

Inlet guide
MGW02419

Inlet bushing
MMV00801

Center gear assy.
MDR02417
See image below

**Bearing for drive roll  
Part # 609ZZ**

Image bearing



**MDR02417**

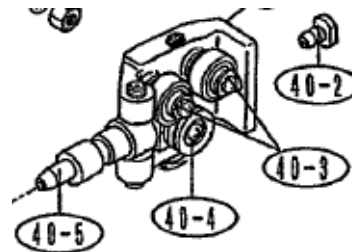

**Wire straightner unit**

40-2	Inlet bushing	MMV00801
40-3	ball bearing	XLC608ZZ0
40-4	guide roller	MGR01901



## Steel 4-roll wire feeder with pancake motor 1/32 gear ratio



**Motor part code PMMEE12MA22K**

**3- hole mounting pattern/ screw part # YZA95**

**Carbon brush part number: 0B1001 2pc.**

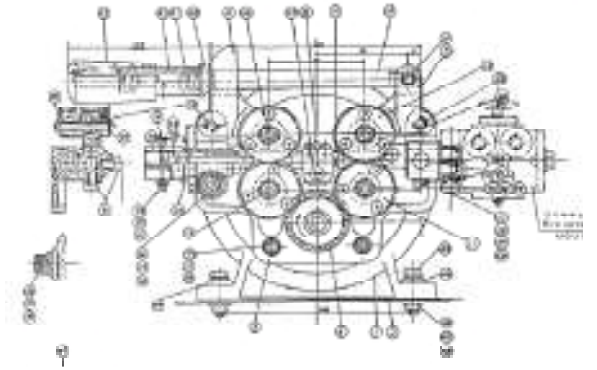

**Drive roll**

Wire Diameter Ø	U-Groove Steel	Outlet guide collared	Outlet guide uncollared	Center guide	Inlet guide	Inlet bushing	Center gear assy.
		MGW00903	MGW00904	MGW00810	MGW02418	MMV00806	MDR02417
0.035"/ 0.045" ( 0.9 mm/ 1.2 mm )	MDR02422	MGW01209	MGW01212				
0.045"/ 0.062" ( 1.2 mm/ 1.6 mm )	MDR02420	MGW01615	MGW01624				

**Bearing for drive roll  
Part # 609ZZ**

Image bearing



**MDR02417**

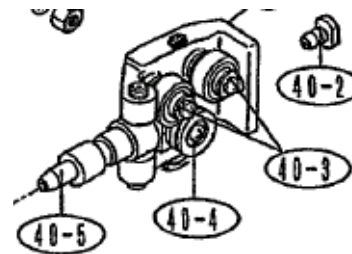

**Wire straightner unit**

40-2	Inlet bushing	MMV00806
40-3	ball bearing	XLC608ZZ0
40-4	guide roller	MGR01901

## Steel 4-roll wire feeder with EL motor and encoder feedback



Motor part code KSV50357

2- hole mounting pattern/ screw part # YZA95

The Steel wire feeder is equipped with 2 Drive rollers and 2 Idle rollers

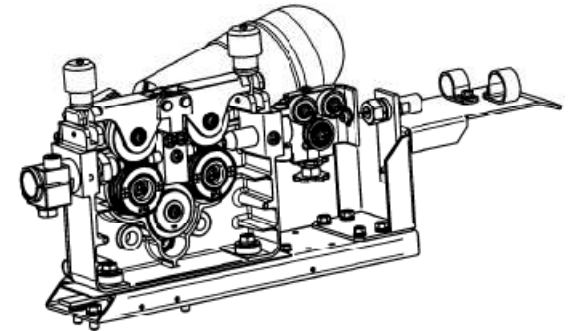

**Drive roll**

Wire Diameter Ø	V-Groove Steel	Knurled Steel	Outlet guide Steel	Idle Roll	Center guide	Inlet guide	Inlet bushing
0.023"/ 0.023" ( 0.6 mm/ 0.6mm )	MDR00043		MGT00808	MDR00060	MGW00012	MGW02418	MMV00806
0.023"/ 0.030" ( 0.6 mm/ 0.8 mm )	MDR00044						
0.030"/ 0.030" ( 0.8 mm/ 0.8 mm )	MDR00045		MGT01205	MDR00060	MGW00010	MGW02418	MMV00806
0.035"/ 0.035" ( 0.9 mm/ 0.9 mm )	MDR00049						
0.035"/ 0.045" ( 0.9 mm/ 1.2 mm )	MDR00051		MGT01608	MDR00060	MGW00010	MGW02418	MMV00806
0.039"/ 0.045" ( 1.0 mm/ 1.2 mm )	MDR00053						
0.045"/ 0.045" ( 1.2 mm/ 1.2 mm )	MDR00054	MDRCT00054		MDR00060	MGW00010	MGW02418	MMV00806
0.045"/ 0.052" ( 1.2 mm/ 1.4 mm )	MDR00055						
0.052"/ 0.052" ( 1.4 mm/ 1.4 mm )	MDR00057	MDRCT00057		MDR00060	MGW00010	MGW02418	MMV00806
0.045"/ 0.062" ( 1.2 mm/ 1.6 mm )	MDR00056						
0.045"/ 0.062" ( 1.4 mm/ 1.6 mm )	MDR00058			MDR00060	MGW00010	MGW02418	MMV00806
0.062"/ 0.062" ( 1.6 mm/ 1.6 mm )	MDR00059	MDRCT00059					

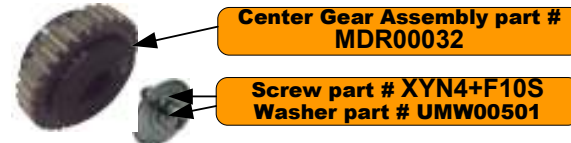
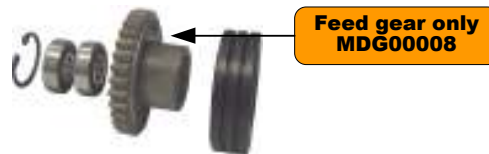

## Steel 2-roll wire feeder with EL motor and encoder feedback

Motor part code **KSV50357**

2- hole mounting pattern/ screw part # **YZA95**

The Steel wire feeder is equipped with  
1 Drive rollers and 1 Idle rollers

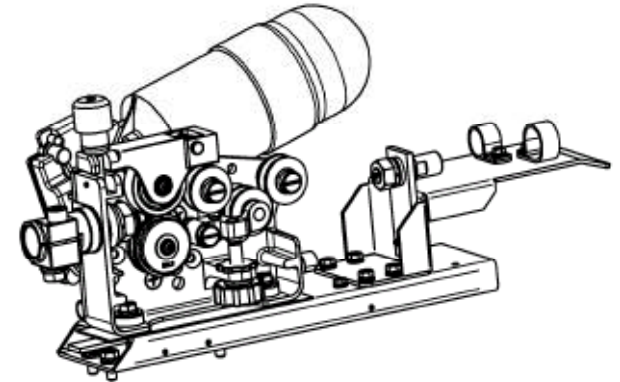

**Drive roll**

Wire Diameter Ø	V-Groove Steel	Knurled Steel	U-Groove	Idle Roll	Outlet guide	Inlet guide	Drive roll screw
0.023"/ 0.023" ( 0.6 mm/ 0.6 mm )	MDR00021			MDR00082	MGT01608	AGM41016	XYN4+ F10S (Screw) UMW00501 (Washer)
0.023"/ 0.030" ( 0.6 mm/ 0.8 mm )	MDR00806						
0.030"/ 0.030" ( 0.8 mm/ 0.8mm )	MDR00007						
0.035"/ 0.035" ( 0.9 mm/ 0.9 mm )	MDR00022						
0.030"/ 0.035" ( 0.8 mm/ 1.0 mm )	MDR01001						
0.035"/ 0.045" ( 0.9 mm/ 1.2 mm )	MDR01227	MDRC62100	MDRC62103				
0.045"/ 0.045" ( 1.2 mm/ 1.2 mm )	MDR01206						
0.052"/ 0.052" ( 1.4 mm/ 1.4 mm )	MDR01403						
0.045"/ 0.052" ( 1.2 mm/ 1.4 mm )	MDR01401						
0.052"/ 0.062" ( 1.2 mm/ 1.6 mm )	MDR01602		MDRC62104				
0.052"/ 0.062" ( 1.4 mm/ 1.6 mm )		MDRC62101					
0.062"/ 0.062" ( 1.6 mm/ 1.6 mm )	MDR01611						
0.062"/ 0.078" ( 1.6 mm/ 2.0 mm )	MDR02002						
0.078"/ 0.093" ( 2.0 mm/ 2.3 mm )		MDRC62102					



## Tawers 4-roll steel feeder with servo motor

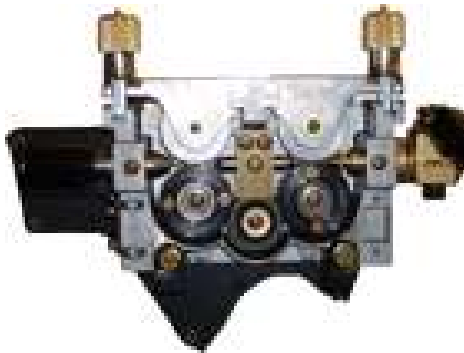

- Feeder part # APU01075 & APU01079**
- 2- hole mounting pattern/ screw part # YZA95**
- The Steel wire feeder is equipped with 2 Drive rollers and 2 Idle rollers**

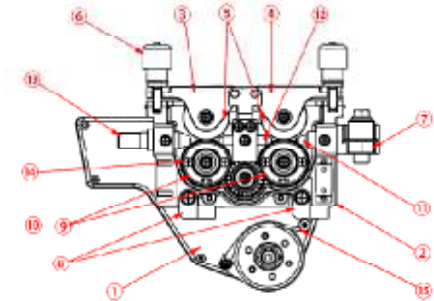

### Drive roll

Wire Diameter Ø	V-Groove Steel	Knurled Steel	Outlet guide Steel	Idle Roll Assy.	Center guide	Center Gear	Feed roll gear assy.
0.023"/ 0.023" ( 0.6 mm/ 0.6mm )	MDR00043		MGT00004	MDR00060	MGW00012	ADR41006	MDG00010 SEE ITEM #2 IN IMAGE BELOW
0.023"/ 0.030" ( 0.6 mm/ 0.8 mm )	MDR00044						
0.030"/ 0.030" ( 0.8 mm/ 0.8 mm )	MDR00045						
0.035/ 0.035" ( 0.9 mm/ 0.9 mm )	MDR00049						
0.035"/ 0.045" ( 0.9 mm/ 1.2 mm )	MDR00051						
0.035"/ 0.045" ( 1.0 mm/ 1.2 mm )	MDR00053						
0.045"/ 0.045" ( 1.2 mm/ 1.2 mm )	MDR00054	MDRCT00054					

Center Gear Assembly part # ADR41006

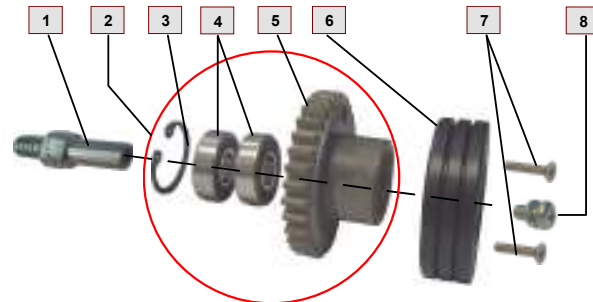
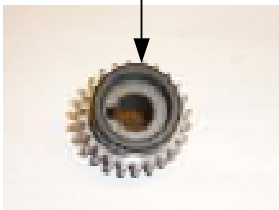

	Part #	Description	Qty
1	MDS00009	Feed roller shaft	2
2	MDG00010	Feed gear assembly	2
3	XUA19FP	Snap ring	2
4	YWA56	Feed roller bearing	4
5	MDG00008	Feed gear only	2
6	See chart	Feed roller	2
7	YZA95	Screw feed roller	4
8	YZA89	Screw center	2

## Tawers 4-roll steel high powered feeder with servo motor



Feeder part # APU01038 & APU01038

2- hole mounting pattern/ screw part # YZA95

The Steel wire feeder is equipped with 2 Drive rollers and 2 Idle rollers



Drive roll

Wire Diameter Ø	V-Groove Steel	Knurled Steel	Outlet guide Steel	Idle Roll Assy.	Center guide	Center Gear	Feed roll gear assy.
0.023"/ 0.023" ( 0.6 mm/ 0.6mm )	MDR00043		MGT00004	MDR00060	MGW00010	ADR41006	MDG00010 SEE ITEM #2 IN IMAGE BELOW
0.023"/ 0.030" ( 0.6 mm/ 0.8 mm )	MDR00044						
0.030"/ 0.030" ( 0.8 mm/ 0.8 mm )	MDR00045						
0.035/ 0.035" ( 0.9 mm/ 0.9 mm )	MDR00049						
0.035"/ 0.045" ( 0.9 mm/ 1.2 mm )	MDR00051						
0.035"/ 0.045" ( 1.0 mm/ 1.2 mm )	MDR00053						
0.035"/ 0.045" ( 1.2 mm/ 1.2 mm )	MDR00054	MDRCT00054					
0.045"/ 0.052" ( 1.2 mm/ 1.4 mm )	MDR00055						
0.052"/ 0.052" ( 1.4 mm/ 1.4 mm )	MDR00057	MDRCT00057					
0.045"/ 0.062" ( 1.2 mm/ 1.6 mm )	MDR00056						
0.045"/ 0.062" ( 1.4 mm/ 1.6 mm )	MDR00058						
0.062"/ 0.062" ( 1.6 mm/ 1.6 mm )	MDR00059	MDRCT00059	MGT00011	MGW00012			



Feed gear only  
MDG00008

2

Center Gear Assembly part #  
ADR41006

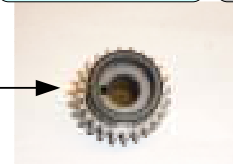

## Tawers 4-roll aluminum feeder with servo motor



Feeder part # APU01075 & APU01079

2- hole mounting pattern/ screw part # YZA95

The Aluminum wire feeder is equipped with 4 Drive rollers

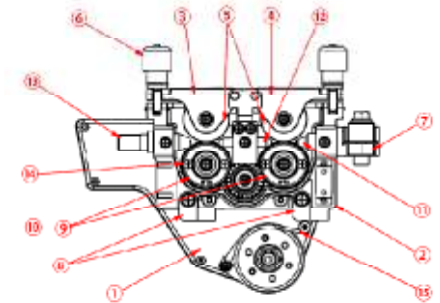

### Drive roll

Wire Diameter Ø	V-Groove	Knurled Steel	Outlet guide	Idle Roll	Center guide	Inlet guide	Feed roll gear assy.
0.030"/ 0.030" ( 0.8 mm/ 0.8 mm )	MDR00068		AGG41089		MGW00017	AGG41078	MDG00012
0.035"/ 0.045" ( 1.0 mm/ 1.2 mm )	MDR00069		AGG41089		MGW00017		
0.045"/ 0.062" ( 1.2 mm/ 1.6 mm )	MDR00081		AGG41090		MGW00018		

Part number	Description	Qty.
MMK00008	BRASS BUSHING *	4
MDS00021	SHAFT *	2
MMN00012	U-NUT *	2
MDG00012	FEED ROLLER GEAR ASSY.	2
MGW00018	CENTER GUIDE 1.6 MM	1
AGG41090	OUTLET GUIDE 1.6 MM	1
MDR00081	DRIVE ROLLER 1.2-1.6	4
MGW00017	CENTER GUIDE 0.8-1.2 MM	1
AGG41090	OULET GUIDE 1.2 MM	1
MDR00069	DRIVE ROLLER 1.0-1.2	4
MGW00017	CENTER GUIDE 0.8-1.2 MM	1
AGG41089	OULET GUIDE 0.8-1.0 MM	1
MDR00068	DRIVE ROLLER 0.8	4

In case a old style feeder is converted the brass bushings, shafts and U - nuts are needed.

These parts can be used to convert a feeder from steel to aluminum application.

Pressure roller assembly old style



Pressure roller assembly new style



## YW-TGF011T01 4-roll TIG steel feeder with servo motor

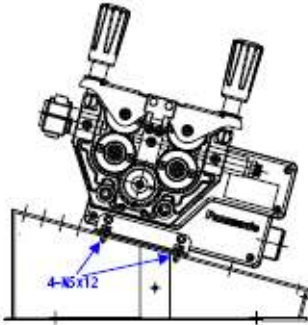

Feed Unit part # ADU01443 / Part Unit MMU00106

2- hole mounting pattern/ screw part # YZA95

The Steel wire feeder is equipped with 2 Drive rollers and 2 Idle rollers

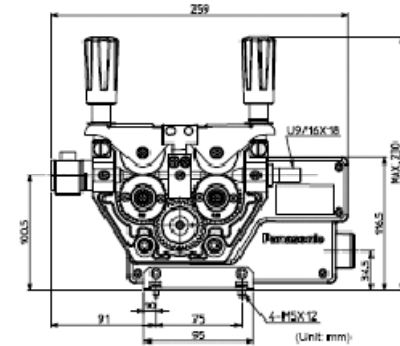

### Drive roll

Wire Diameter Ø	V-Groove Steel	Driving gear	Outlet guide Steel	Idle Roll Assy.	Center guide	Inlet guide	Feed roller gear assy.
0.023"/ 0.023" ( 0.6 mm/ 0.6mm )	MDR00043	MDR00032	MGT00017	MDR00060	MGW00012	MGW00016	MDG00010
0.023"/ 0.030" ( 0.6 mm/ 0.8 mm )	MDR00044		MGT00004				
0.030"/ 0.030" ( 0.8 mm/ 0.8 mm )	MDR00045						
0.035"/ 0.035" ( 0.9 mm/ 0.9 mm )	MDR00049						
0.035"/ 0.045" ( 0.9 mm/ 1.2 mm )	MDR00051						
0.035"/ 0.045" ( 1.0 mm/ 1.2 mm )	MDR00053						
0.045"/ 0.052" ( 1.2 mm/ 1.2 mm )	MDR00054						
0.045"/ 0.052" ( 1.2 mm/ 1.4 mm )							
0.052"/ 0.052" ( 1.4 mm/ 1.4 mm )							
0.045"/ 0.062" ( 1.2 mm/ 1.6 mm )							
0.045"/ 0.062" ( 1.4 mm/ 1.6 mm )	MDR00058						
0.062"/ 0.062" ( 1.6 mm/ 1.6 mm )							



5

5

Feed gear assy.

MDG00010

## YW-TGF011T02 4-roller TIG aluminum feeder with servo motor

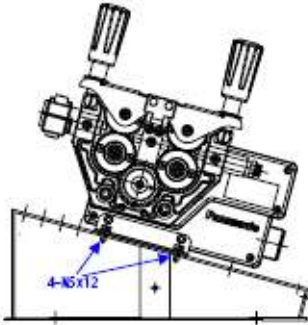

Feed Unit part # ADU01440 / Part Unit MMU00105

2-hole mounting pattern/ screw part # YZA95

The aluminum feeder is equipped with 4 Drive rollers

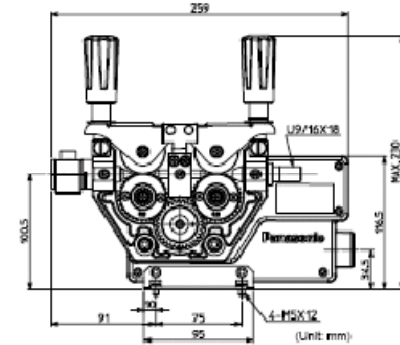

### Drive roller

#### Wire Diameter Ø

0.030"/ 0.030" ( 0.8 mm/ 0.8 mm )

0.035"/ 0.045" ( 1.0 mm/ 1.2 mm )

0.045"/ 0.062" ( 1.2 mm/ 1.6 mm )

#### V-Groove Steel

MDR00068

MDR00069

MDR00081

#### Driving gear

MDR00032

#### Outlet guide Steel

MGW00020

MGW00021

MGW00022

#### Idle Roller Assy.

MDR00060

#### Center guide

MGW00017

MGW00017

MGW00018

#### Inlet guide

AGT41071

#### Feed roll gear assy.

MDG00010

SEE ITEM #2 IN IMAGE BELOW

#### Drive Gear Assembly part # MDR00032



Screw part # XYN4+F10S  
Washer part # UMW00501

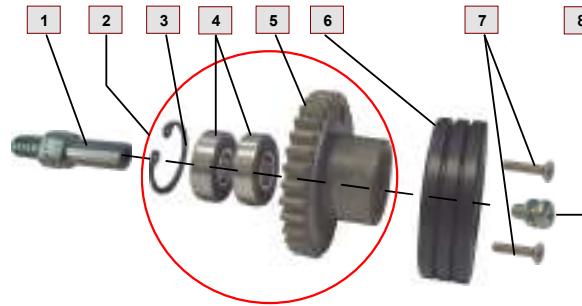

	Part #	Description	Qty
1	MDS00009	Feed roller shaft	2
2	MDG00012	Feed gear assembly	2
3	XUA19FP	Snap ring	2
4	YWA56	Feed roller bearing	4
5	MDG00008	Feed gear only	2
6	See chart	Feed roller	2
7	YZA95	Screw feed roller	4
8	YZA89	Screw center	2



## Steel feeder to aluminum conversion kit for 1.2 mm wire

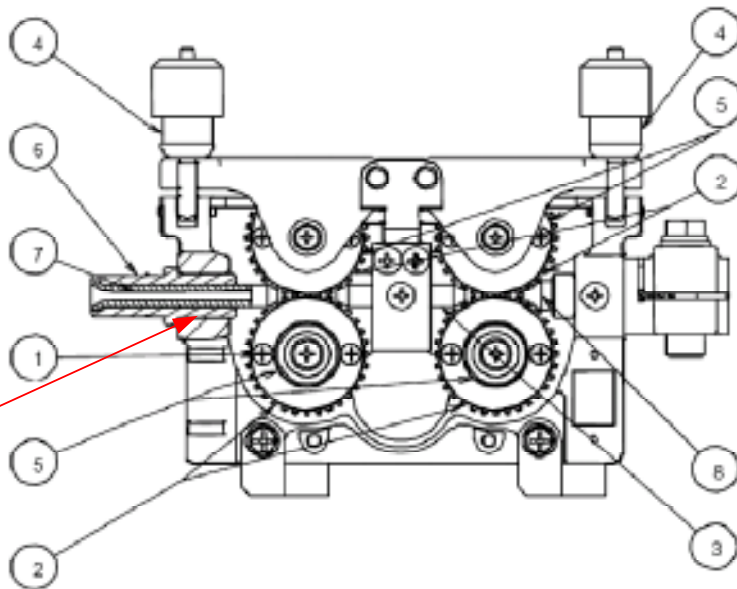

See Note:

Aluminum feeder conversion kit AXU01331				
No.	Part name	Part number	Qty	Note
1	Screw Feed roller	YZA95	8	For feed rollers
2	Feed roller gear unit	MDG00012	4	
3	Center guide	MGW00018	1	
4	Pressure control tube assy.	MNX00017	2	
5	Pressure roller	MDR00081	4	
6	Flexible conduit fitting AL	AGB41008	1	
7	Inlet guide AL	AGG41078	1	
8	Outlet guide 12A	AGG41089	1	For 1.2mm wire

Feeder conversion kit for standard steel feeders to aluminum application feeder.

For the following series of feeders:

APU01075 (Tawers)

APU01079 (Tawers)

YW-CMF011T series (4 roller versions only)

YW-CNF011T series (4 roller versions only)

YW-CGF021T series (4 roller versions only)

Note : The CMF/CNF and CGF UF base part number MDB00008 needs to modified to fit the flexible conduit fitting AGG41078. The UF base cast need to machined from 14 mm to 15 mm (19/32), where the flexible conduit fitting is inserted.

**Steel feeder to aluminum conversion kit for 1.6 mm wire**

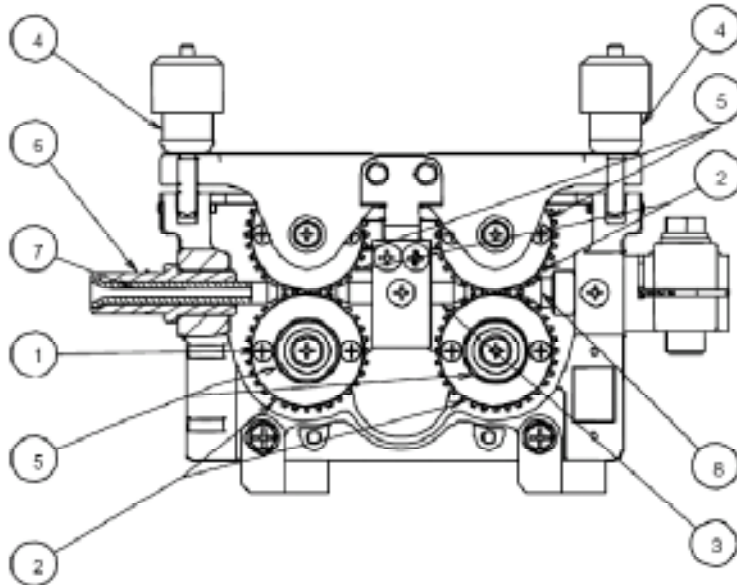

Aluminum feeder conversion kit AXU01331 for 1.6 mm				
No.	Part name	Part number	Qty	Note
1	Screw Feed roller	YZA95	8	For feed rollers
2	Feed roller gear unit	MDG00012	4	
3	Center guide	MGW00018	1	
4	Pressure control tube assy.	MNX00017	2	
5	Pressure roller	MDR00081	4	
6	Flexible conduit fitting AL	AGB41008	1	
7	Inlet guide AL	AGG41078	1	
8	Outlet guide 12A	AGG41089	1	For 1.2 mm wire
8a *	Outlet guide 12A	AGG41090	1	For 1.6 mm wire
* Item 8a* needs to be purchases additional to kit AXU01331				

Feeder conversion kit for standard steel feeders to aluminum application feeder.

For the following series of feeders:

APU01075 (Tawers)

APU01079 (Tawers)

YW-CMF011T series (4 roller versions only)

YW-CNF011T series (4 roller versions only)

YW-CGF021T series (4 roller versions only)

Note : The CMF/CNF and CGF UF base part number MDB00008 needs to modified to fit the flexible conduit fitting AGG41078. The UF base cast need to machined from 14 mm to 15 mm, where the flexible conduit fitting is inserted.